

Sign Up Process

Residents can sign up for Morgan County Alerts online through an online portal. Go to <https://www.smart911.com/smart911/ref/reg.action?pa=morgancountywv> or use the QR Code.



Once you are at the sign up page you will be asked to create an account.

You must provide:

- Preferred Language
- Your name
- Phone Number
- And create a username and password

Your e-mail address is optional.

The system also allows you to designate some who will provide assistance in setting you up and managing your account. If you choose this option the person assisting will get reminders to update your information on an annual basis.

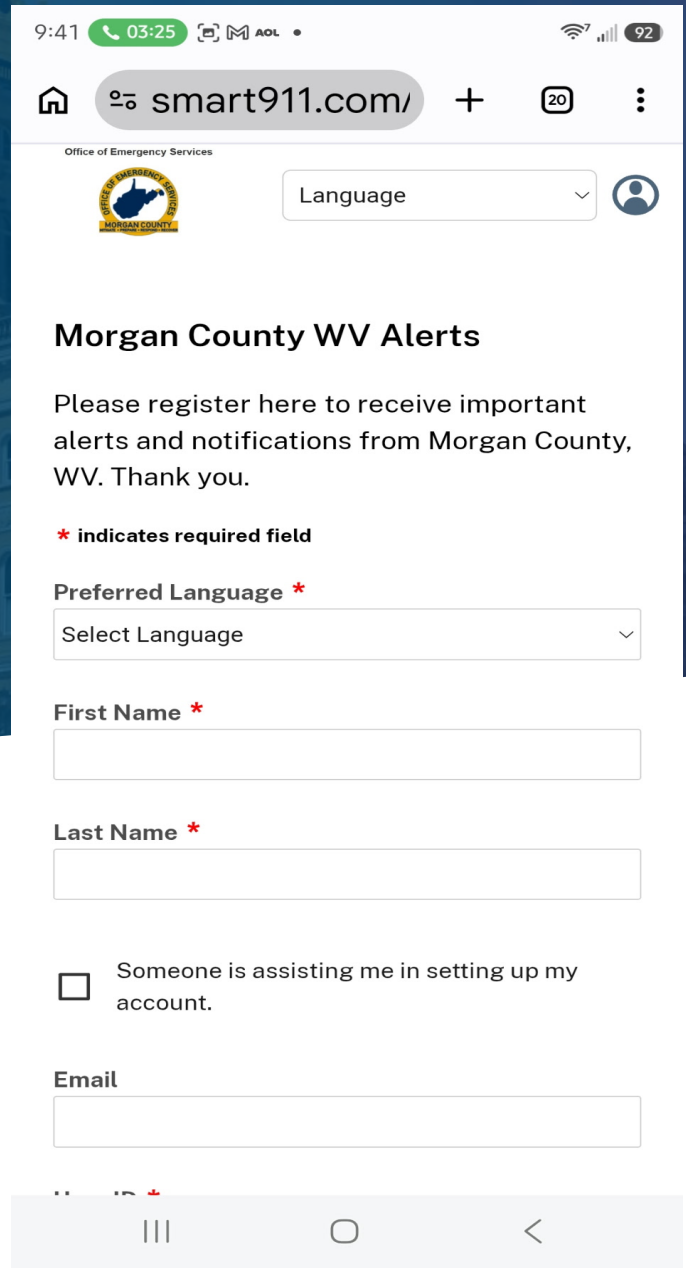

Download the Smart911 APP

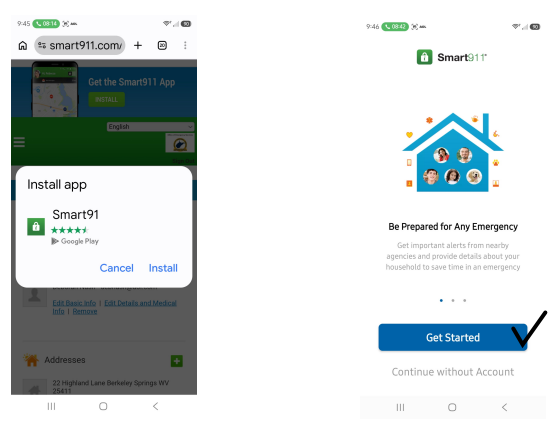

Once you create your account, the next few pages will review your personal information.

Adding an Email

If you choose to not include an email you will be asked to verify, and if you entered a mobile number you will be asked to verify the carrier by a call.

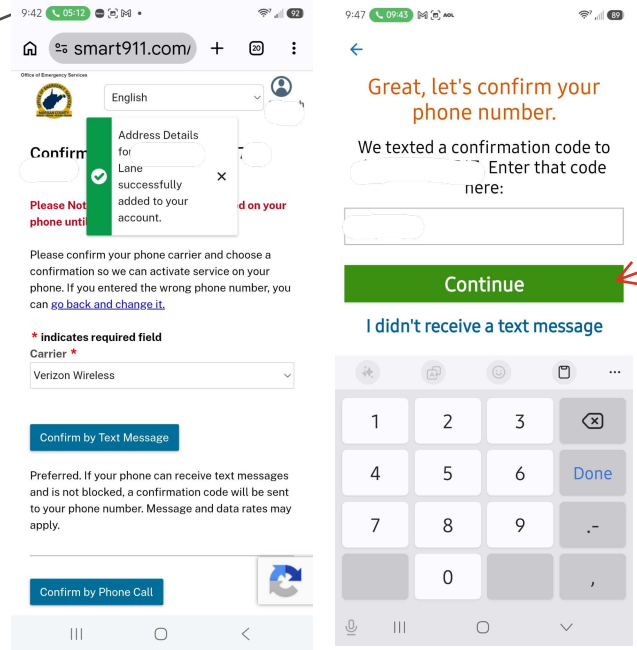

Build your profile

You will then be asked to enter in an address. This is needed to confirm what alerts you will be offered.

Note: You can add multiple address in different counties in your profile in a later step.

Add any additional information you would like to share. All information is confidential and only visible if you dial 911.

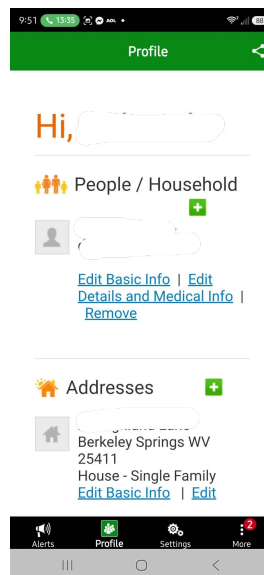

People & Medical Information

You can add multiple people under one account, making this a great way to sign up a whole household. If you opt-in to provide your personal information, such as personal medical and access and functional needs information, Your emergency management agency can use this information to send preemptive messaging to groups who may need extra time to evacuate, or rely on generators.

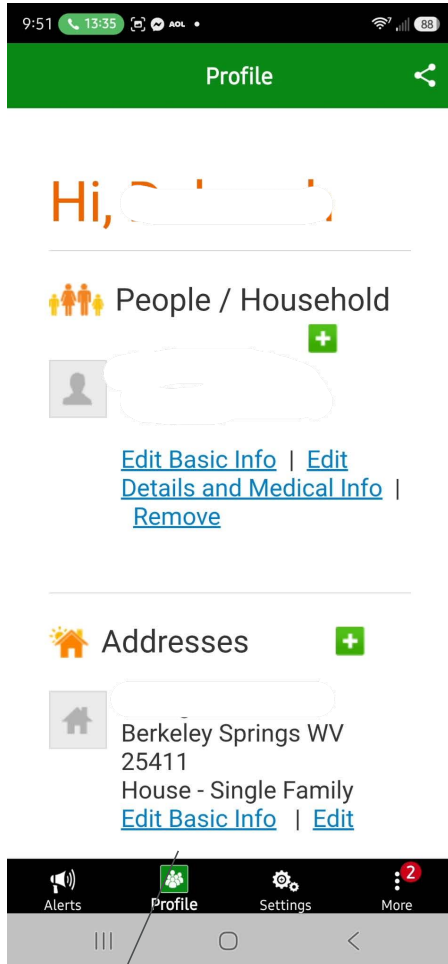

Addresses

The system allows for multiple addresses that can span across the country. The address will activate which alerts you have the ability to opt into.

Account Settings

You can update your password, profile update reminders, and account assistant information in the Account Settings tab.

Alerts

Smart911 gives you the option for both Location-Based Alerts and Subscription-Based Alerts.

Activating Location-Based Alerts will allow you to receive alerts based upon your **physical** location. Set the Radius you wish and you will receive weather and national alerts. You may also receive alerts if you are in a jurisdiction that use Smart911.

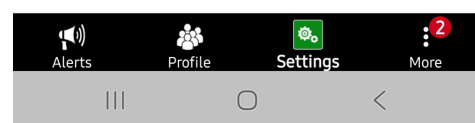
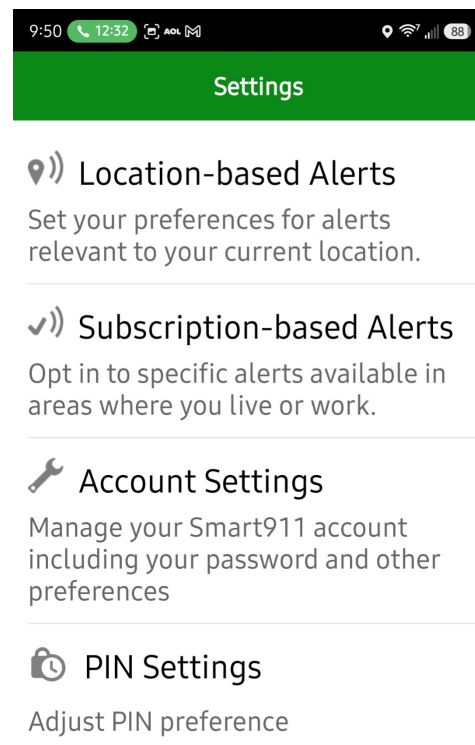

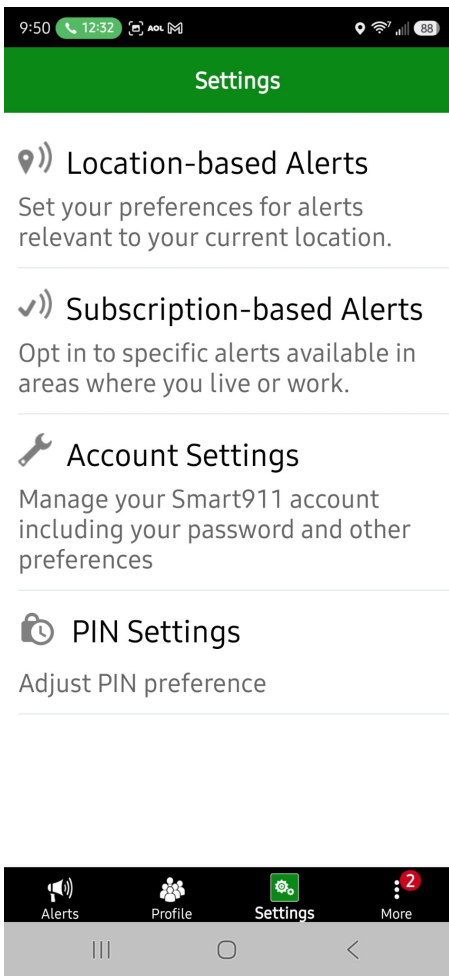

Location-based Alerts

Set your preferences for alerts relevant to your current location.

Subscription-based Alerts

Opt in to specific alerts available in areas where you live or work.

Account Settings

Manage your Smart911 account including your password and other preferences

PIN Settings

Adjust PIN preference

SELECT ALL NOTIFICATION METHODS YOU WISH TO USE

SUBSCRIPTION-BASED ALERTS

Opt-in to Subscription-Based Alerts and you will receive Alerts for Morgan County, WV.

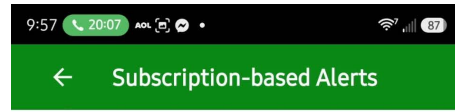

Contact Methods

Select the phone numbers and/or Emails you want to receive subscription-based alerts.

Phone Numbers

(mobile)

Emails

Subscribe To:

Emergency Notifications from M...



TEXT

EMAIL

VOICE

Set Slider to receive alerts

Other Account Information

You can populate information about emergency contacts, preferred providers, vehicles and animals in your household. Some counties use this for response and recovery efforts across the state, and a few counties can pull this information into their 911 dispatch centers when you place a call.

Note: Participation across the State of West Virginia is determined on a county basis.

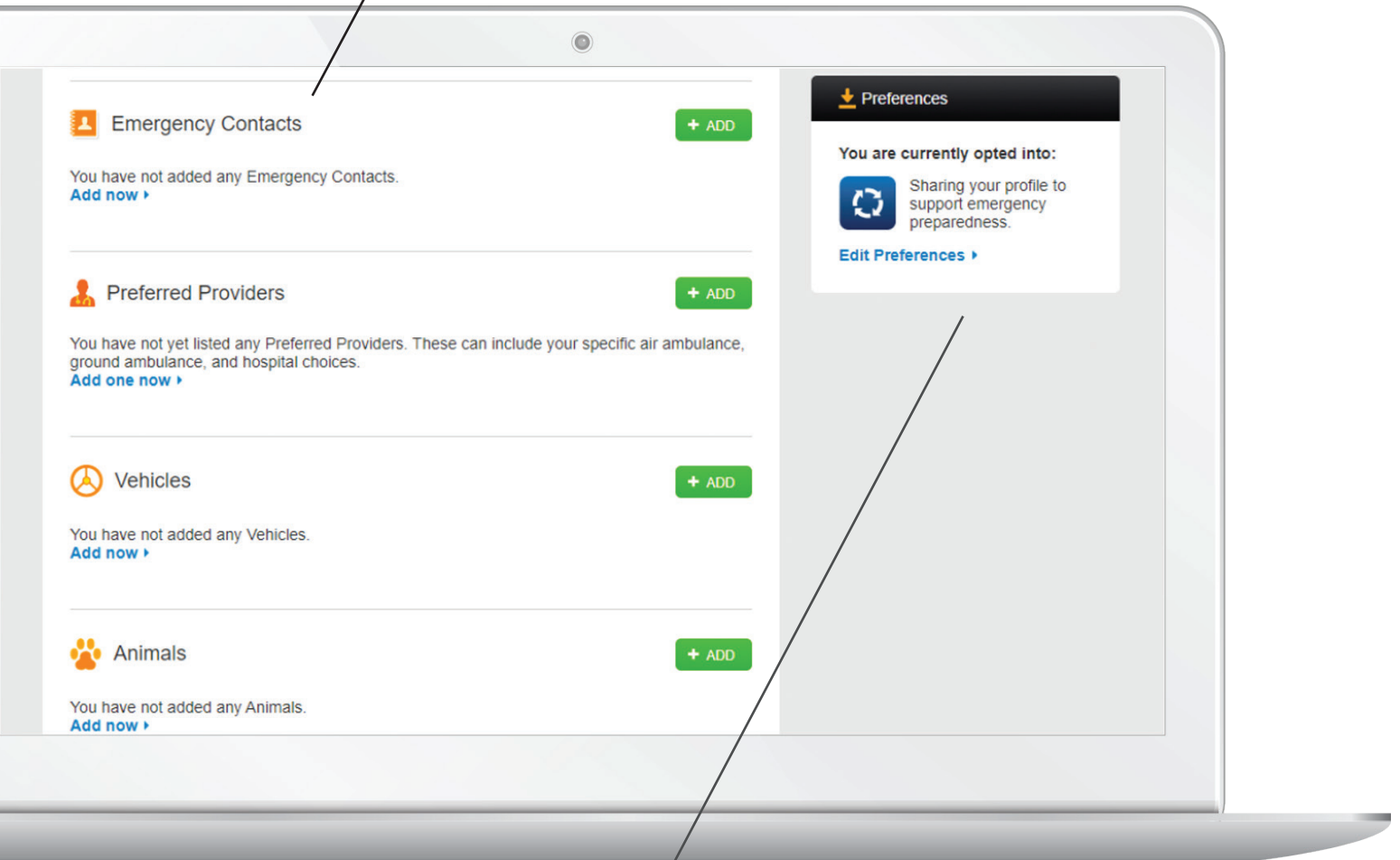

Preferences

You can manage the option to provide personal information to your local emergency management agency to assist them in response, evacuation and recovery efforts under "Preferences".

Note: Not all Counties may participate in this feature.

If you are still having difficulty setting up your Smart911 Account, call 304-867-3145 for assistance. You may also visit the Morgan County Public Library for in-person assistance.